

Type ST43

FEATURES

Double mechanical seal (configuration back to back).

APPLICATION

Wastewater pumps, submersible pumps.

OPERATING LIMITS

P = 3 bar

V = 15 m/s

T = -20 ÷ 140°C



MATERIALS (EN 12756)

| ID | DESCRIPTION | MATERIALS | | | |
|----|-------------------|-----------|---|---|--|
| | | A | B | Q | |
| 1 | Seal face | A | B | Q | |
| 2 | Seat | V | Q | | |
| 3 | Elastomer | P | E | V | |
| 4 | Spring | F | G | | |
| 5 | Other metal parts | F | G | | |

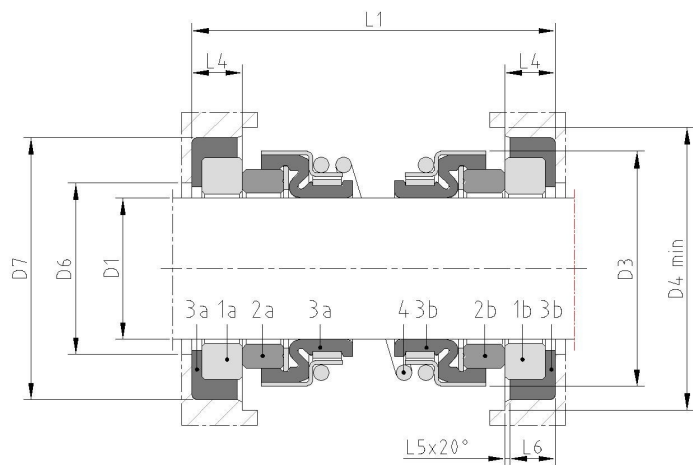

| D1 | D3 | D4 | D6 | D7 | L1 | L4 | L5 | L6 |
|------|----|----|----|-------|------|----|-----|-----|
| 12 | 22 | 25 | 14 | 25 | 25,0 | 4 | 0,5 | 4 |
| 14 | 24 | 27 | 17 | 26 | 32,5 | 4 | 0,5 | 4 |
| 15 | 28 | 31 | 19 | 29 | 32,5 | 3 | 1,0 | 3 |
| 16 | 28 | 31 | 19 | 29 | 32,5 | 3 | 1,0 | 3 |
| 25,4 | 42 | 46 | 29 | 41,25 | 55,0 | 11 | 1,5 | 8,5 |